

Recommended Graphic Thickness: 225-450microns
 Total Visual Graphic Area: 800x2130mm
 Total Visual Graphic Area: 1000x2130mm

Include a 150mm at the bottom (non-visible area in roller mechanism)

Assembly

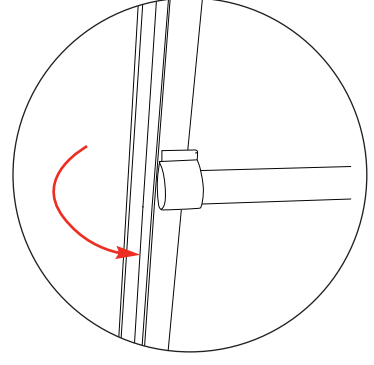
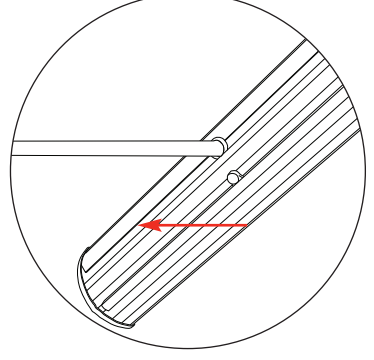
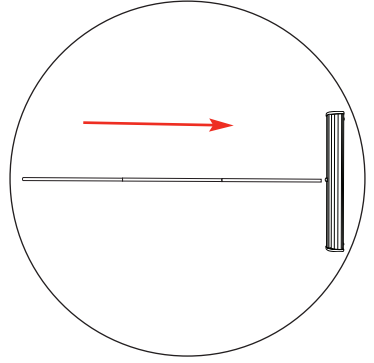
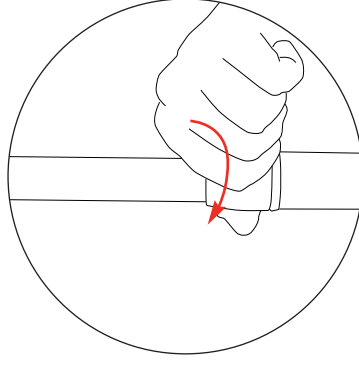
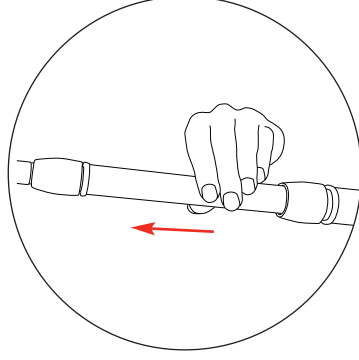
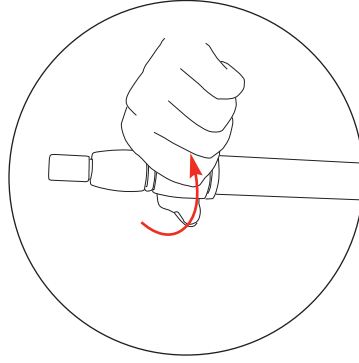

Top Rail Attachment

Option 1 (Adhesive Rail Option)

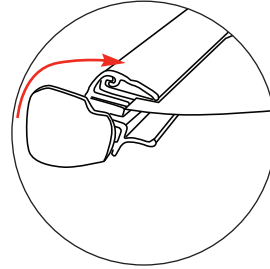
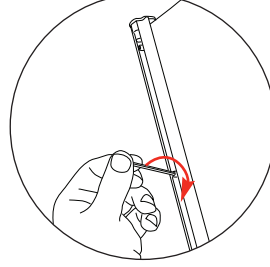
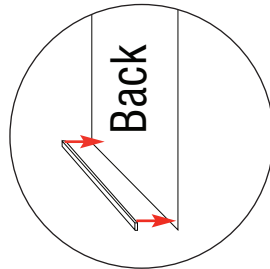
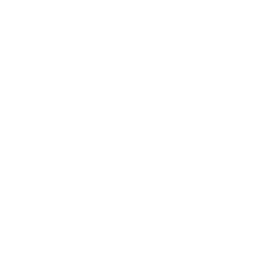
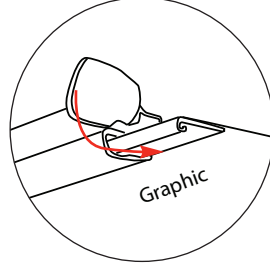
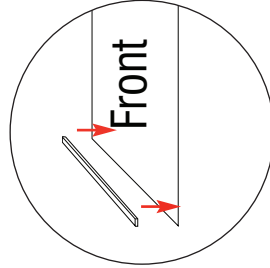
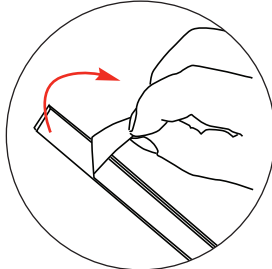
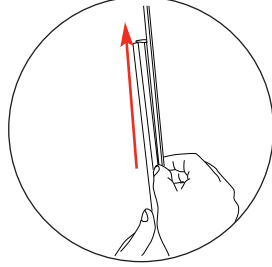
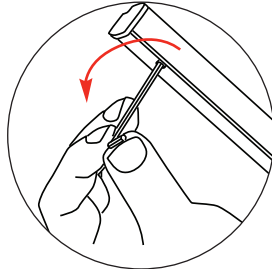
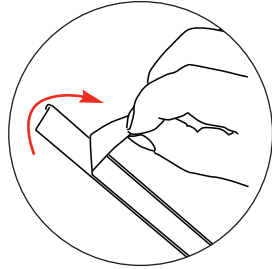
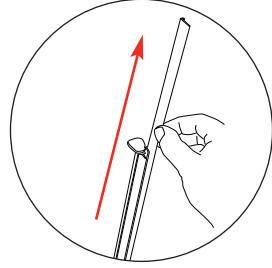
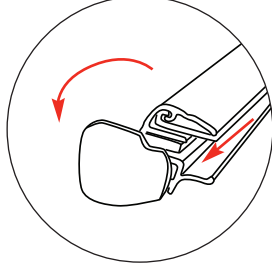

Bottom Graphic Attachment

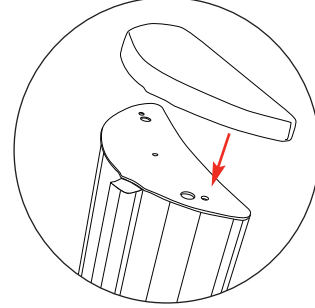
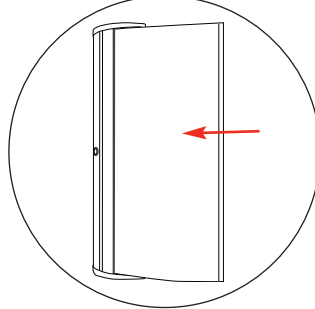
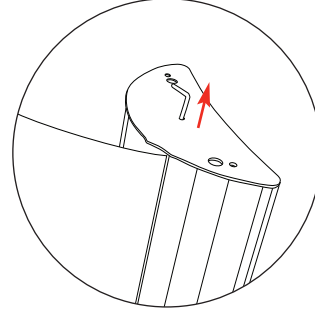
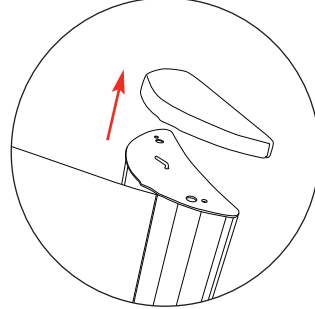
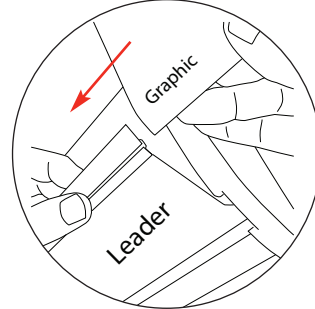
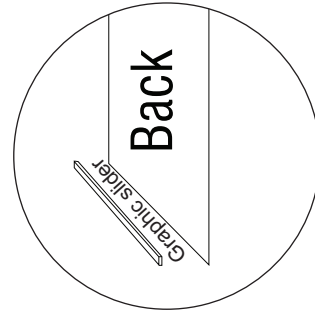

Option 2 (Clamp Rail Option)

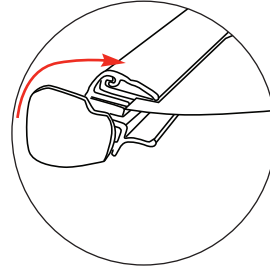
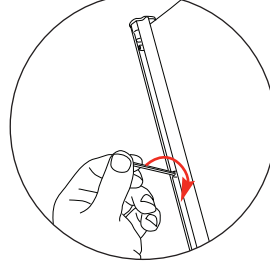
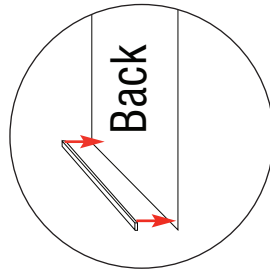
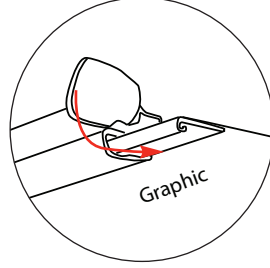
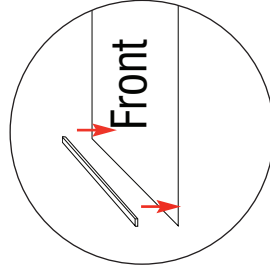
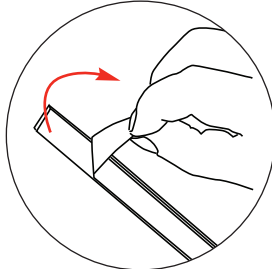
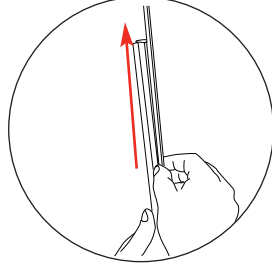
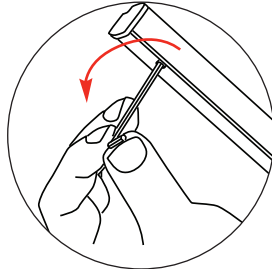
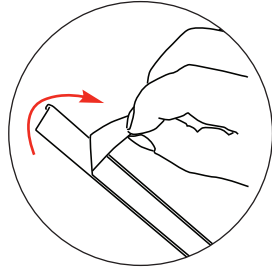
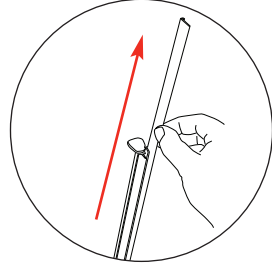
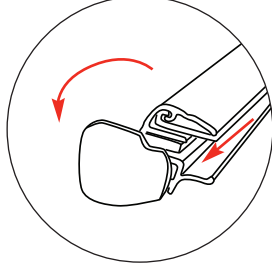

Bottom Graphic Attachment

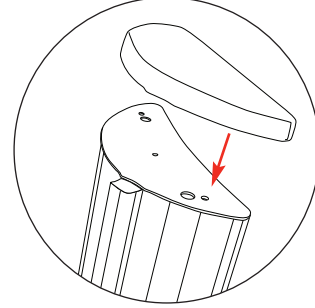
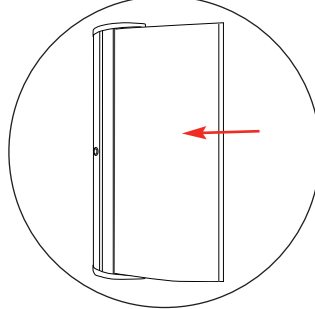
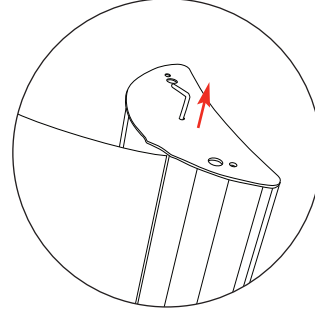
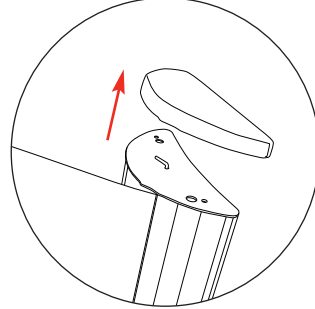
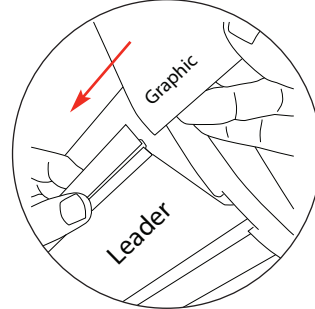
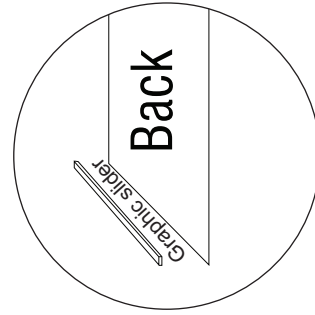

WARNING: Banner is pre-tensioned always attach graphic to Leader and top rail before removing the locking pin.